

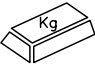

# CAJA D.349

## ALGUNAS POSIBILIDADES DE USO:

|   |        |
|---|--------|
|  | 70,5   |
|  | SAE 90 |

Vista Desde A

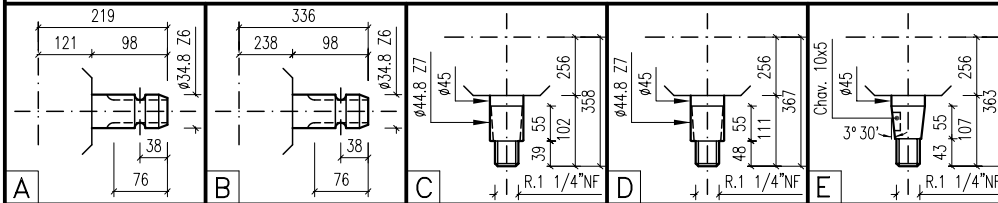
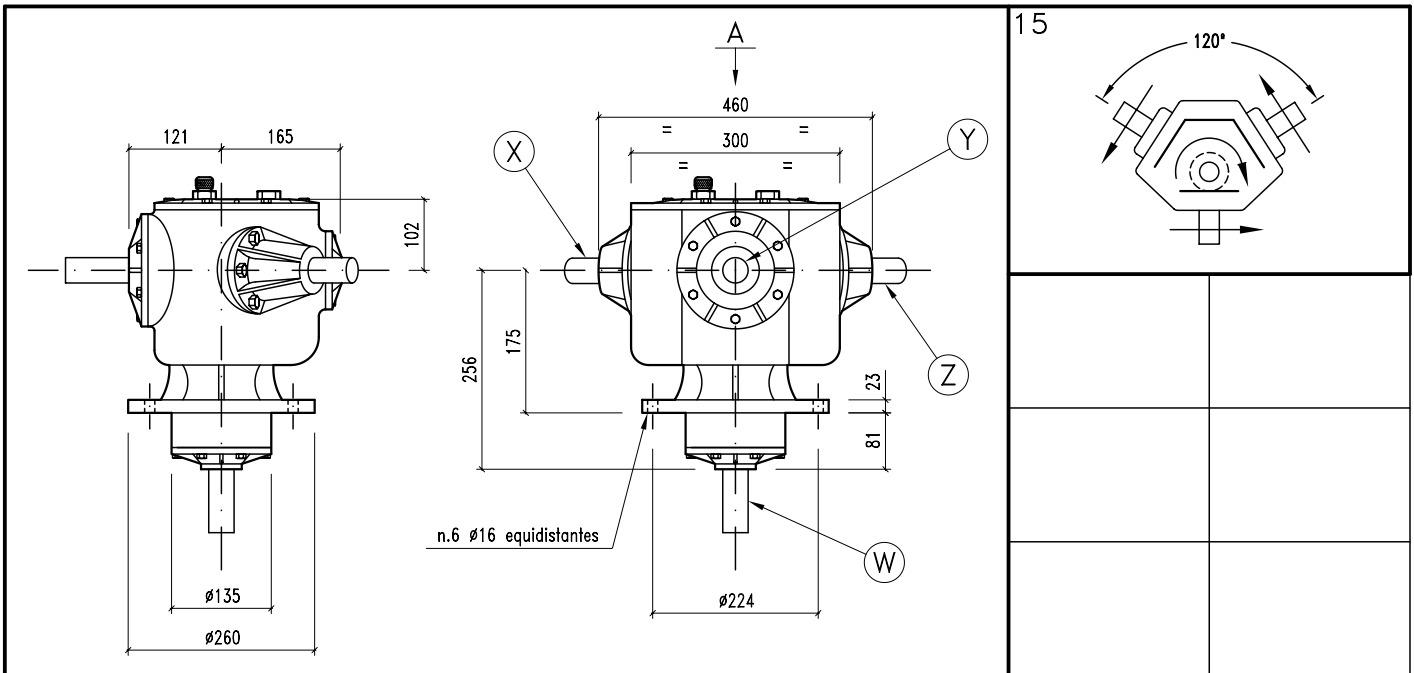

| i     | r.p.m. | HP | KW | W | X | Y | Z | ARMADO | ENTRADA | CODIGO | CODIGO |
|-------|--------|----|----|---|---|---|---|--------|---------|--------|--------|
| VER * | 540    |    |    | C | B | A | B | 15     | Y       | 15     | 113    |
| VER * | 540    |    |    | D | B | A | B | 15     | Y       | 15     | 183    |
| VER * | 540    |    |    | E | B | A | B | 15     | Y       | 15     | 342    |

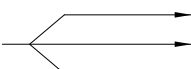
\* RELACIONES DE TRANSMISION:  ENTRE Y-W RELACION 1:1,5  
 ENTRE Y-X RELACION 1:1  
 ENTRE Y-Z RELACION 1:1

