

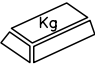

CAJA G.455

ALGUNAS POSIBILIDADES DE USO:

* Tolvas a sin fin.



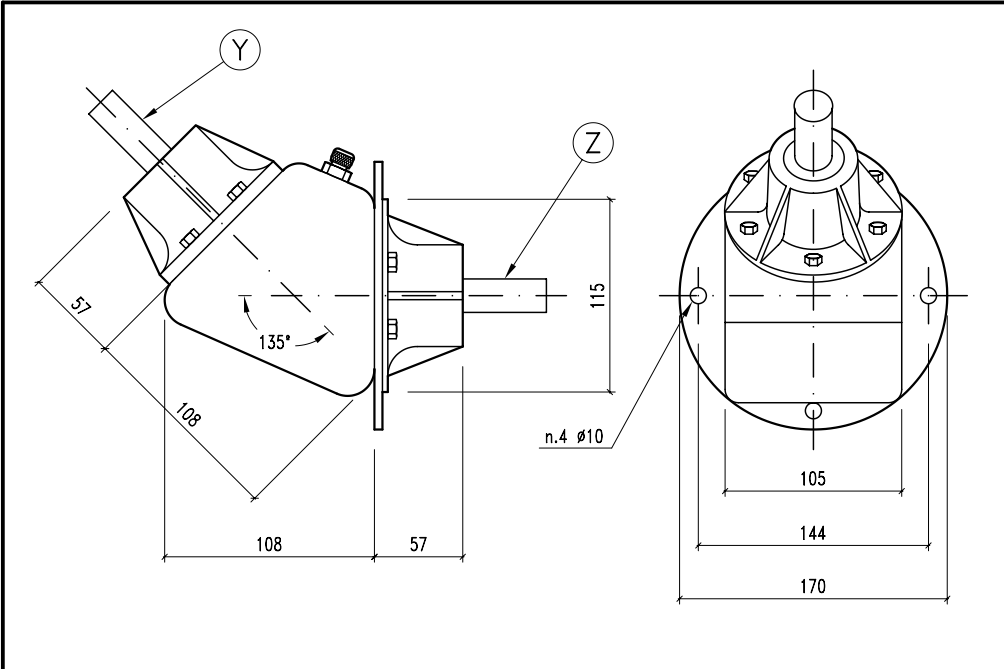
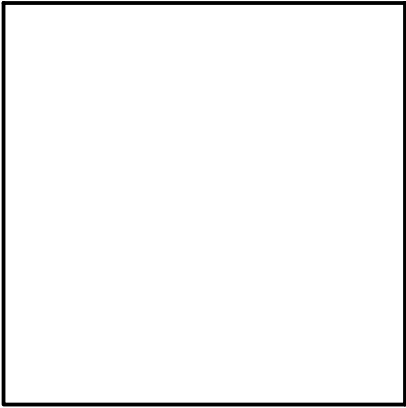

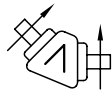

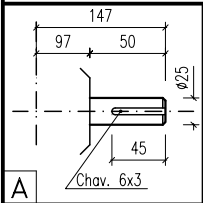
	4,5
	SAE 90

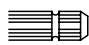

10	

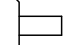
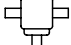
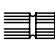

--	--	--	--	--	--	--	--	--	--	--	--

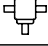
↑↑↑												
	i	r.p.m.	HP	KW	X	Y	Z	ARMADO	ENTRADA		CODIGO	
1:1	540	8	5,88		A	A	10	Y	10	336		

