

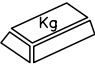

CAJA M.127-30-2T

ALGUNAS POSIBILIDADES DE USO:



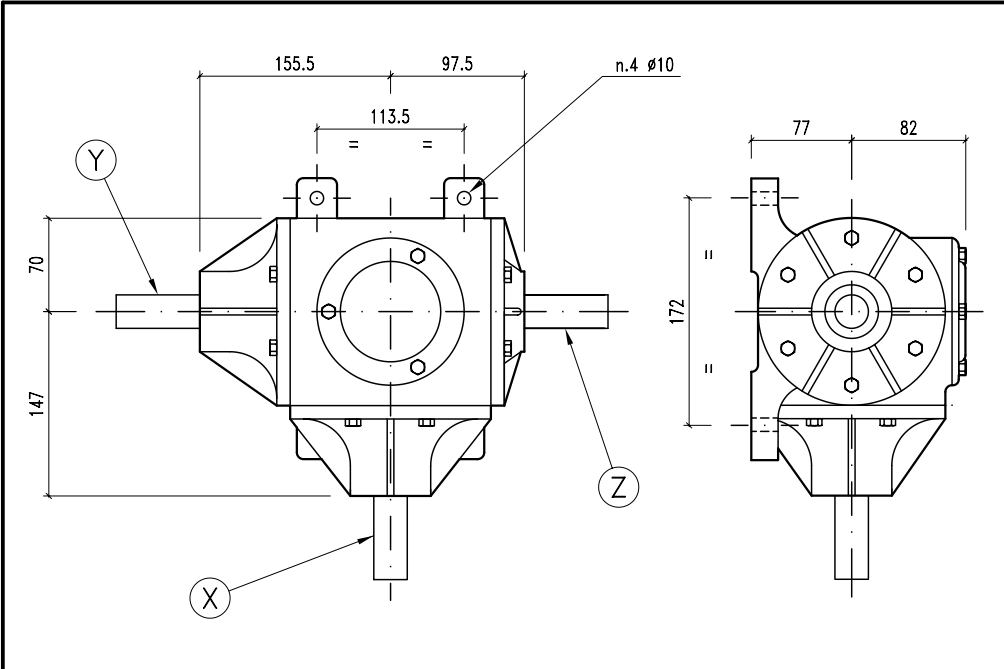
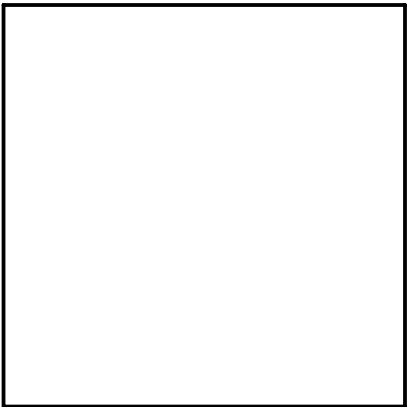

- * Elevadores de granos a sin fin.
- * Elevadores de granos con chamiquera.
- * Cintas transportadoras.

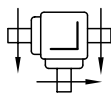
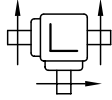
	19
	SAE 90

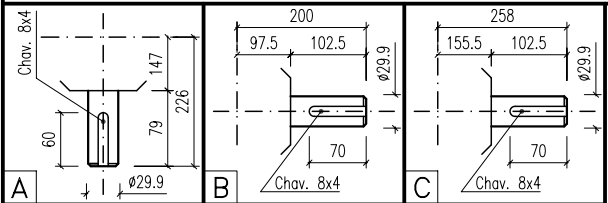

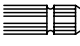
29 	30 

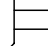
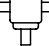
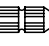

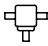
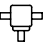
↑													
	i	r.p.m.	HP	KW	X	Y	Z	ARMADO	ENTRADA		CODIGO		CODIGO
	1:1	540	20	14,71	A	C	B	29-30	X-Y-Z	29	455	30	456

