

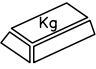

CAJA M.128-25M

ALGUNAS POSIBILIDADES DE USO:

- * Elevadores de granos a sin fin.
- * Carros tolva.

	18
	SAE 90

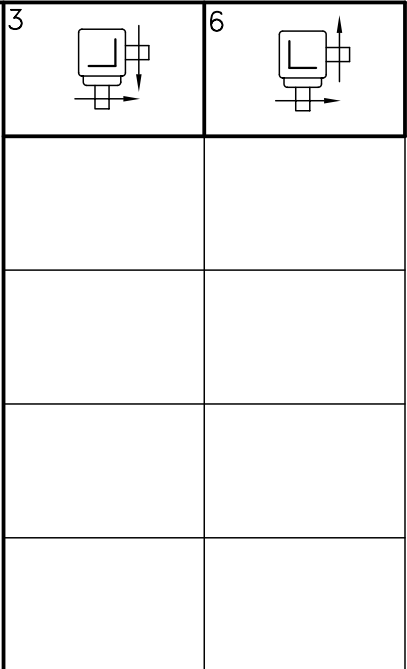
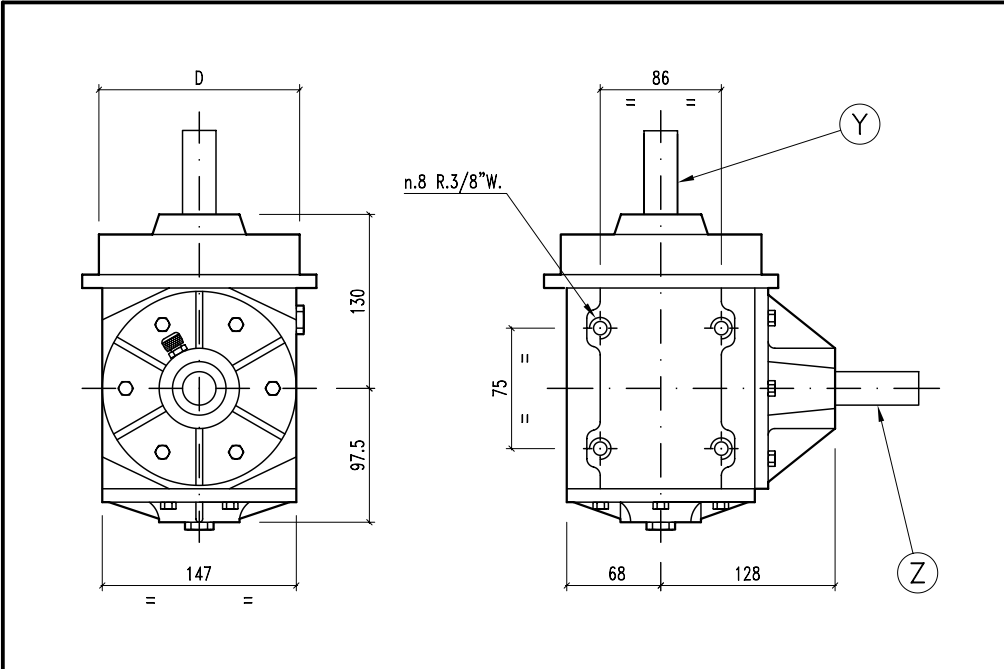
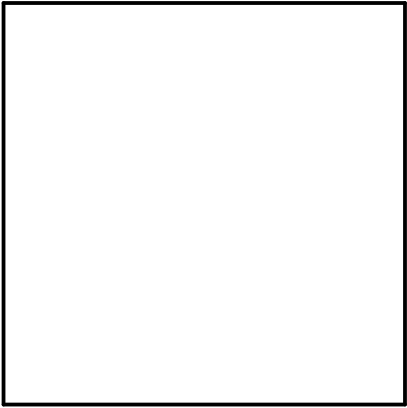

--	--	--	--	--	--

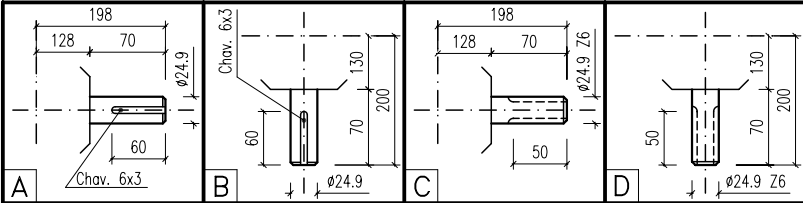





--	--	--	--	--	--

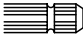

--	--	--	--	--	--

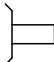
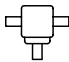
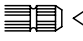
CAJA M.128-25M

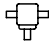
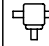
																
i	r.p.m.	HP	KW	X	Y	Z	ARMADO	ENTRADA	D		CODIGO		CODIGO			
1:1	540	15	11,03		B	A	3-6	Z	160	3	349	6	350			
1:1	540	15	11,03		B	C	3-6	Z	160	3	351	6	352			
1:1	540	15	11,03		D	A	3-6	Z	160	3	397	6	398			
1:1	540	15	11,03		D	C	3-6	Z	160	3	399	6	400			
1:1	540	15	11,03		B	A	3-6	Z	180	3	353	6	354			
1:1	540	15	11,03		B	C	3-6	Z	180	3	355	6	356			
1:1	540	15	11,03		D	A	3-6	Z	180	3	401	6	402			
1:1	540	15	11,03		D	C	3-6	Z	180	3	403	6	404			
1:1	540	15	11,03		B	A	3-6	Z	200	3	357	6	358			
1:1	540	15	11,03		B	C	3-6	Z	200	3	359	6	360			
1:1	540	15	11,03		D	A	3-6	Z	200	3	405	6	406			
1:1	540	15	11,03		D	C	3-6	Z	200	3	407	6	408			
1:1	540	15	11,03		B	A	3-6	Z	210	3	361	6	362			
1:1	540	15	11,03		B	C	3-6	Z	210	3	363	6	364			
1:1	540	15	11,03		D	A	3-6	Z	210	3	409	6	410			
1:1	540	15	11,03		D	C	3-6	Z	210	3	411	6	412			



		 GARRO FABRIL S.A.			