

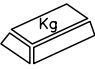

CAJA P 0-6





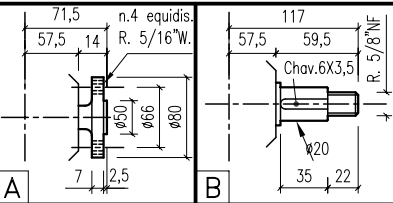
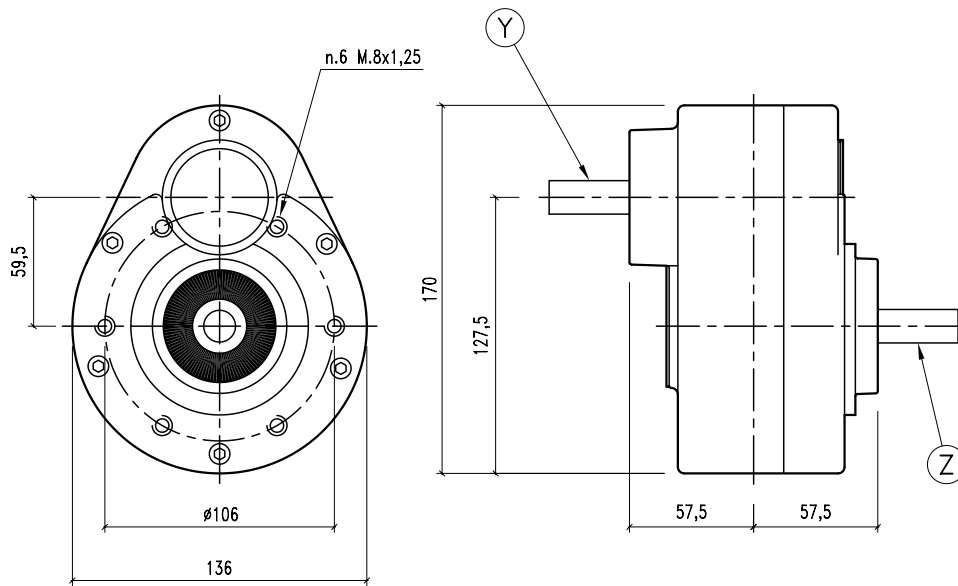
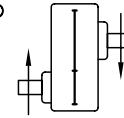

ALGUNAS POSIBILIDADES DE USO:

* Tolva para silos.

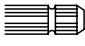
	7
	SAE 90

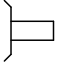
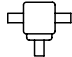
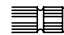
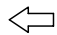
25

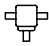
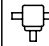

														
	i	r.p.m.	HP	KW	X	Y	Z	ARMADO	ENTRADA	BRIDA		CODIGO		CODIGO
	4,09:1	540	6	4,42		B	A	25	Y	accesorio s/necesidad	25	784		

