



COMPANY —	DATE 26-06-2006	CODE 001151 - B	DESIGNATION Z.M.1080
--------------	--------------------	--------------------	-------------------------

NOTES:

*Ratio between z and x - 1:1.210

*Ratio between z and y - 1:0.507

- ① Gear teeth number between z and x
- ② Gear teeth number between w and x
- ③ Gear teeth number between w and y

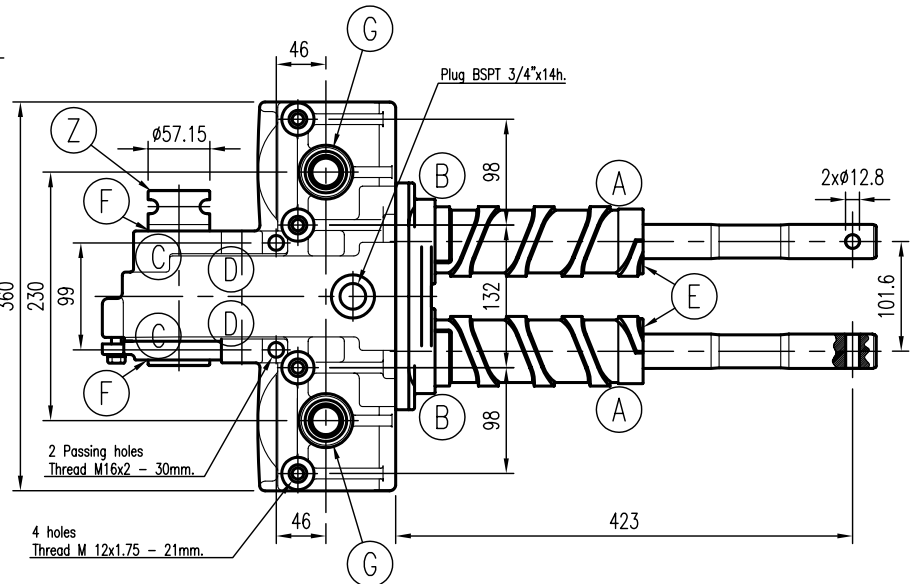
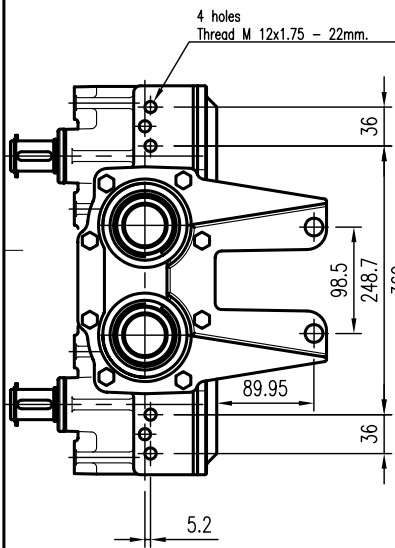
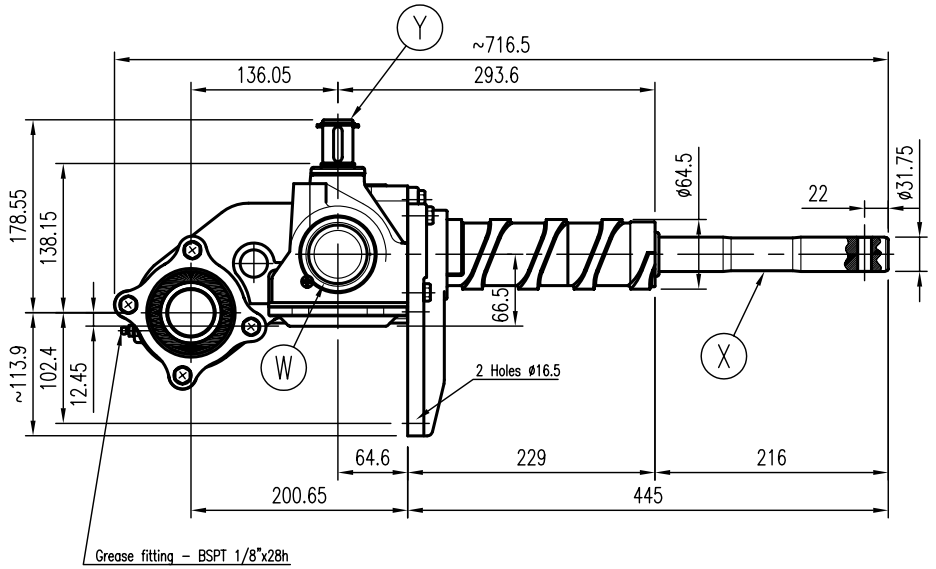

Row unit gearbox	Ratio	Rated input r.p.m.	Rated input power HP	Rated input power KW	Rated output torque da Nm (X)	Rated output torque da Nm (Y)	Weight Kg	Lubricant Oil	Lubricant Grease	Lubricant Type	Qty. Kgs.					
	*	700	60	44.1	49.7	118.6	44		X	NGLI #0	1.6					
		Gear arrangement				Bevel couplings				Cylindrical couplings				Bearings		
		Helicoidal	Straight	Teeth number		Module	Helicoidal	Straight	Teeth number		Module	A	BHA 2020 ZO			
				Z1	Z2	Z3	*	M					B	6207		
			X	23	17		②	4.1		X	17	17	19	①	4.23	C
		X	17	30		③	3.4								D	BHA 1612 ZO
	Components material												Seals			
	Housing and spindle	Shaft W	Shaft X	Shaft Y	Shaft Z	Gears		E	31.75x52.15x15.6							
	Nodular cast iron	Steel S.A.E 1045 Tempered	Steel S.A.E 4140 Tempered	Steel S.A.E 4140 Tempered	Steel S.A.E 8620 Case hardened	Steel S.A.E 8620 Case hardened		F	57.15x76.2x9.52							
							G	28.5x38x7.2								

GARRO FABRIL reserves the right to make any change to this product without prior public acknowledgement